



STRAIGHT HANGER

DESCRIPTION AND USES

Accessory designed for suspending F60 rails in continuous suspended ceilings.

An optimized and versatile design, fastened to the rail by pressure, without screws.

Suspended from the upper floor structure or ceiling with an M6 threaded rod or with a smooth rod ending in a hook.



DIMENSIONS AND ASSEMBLY

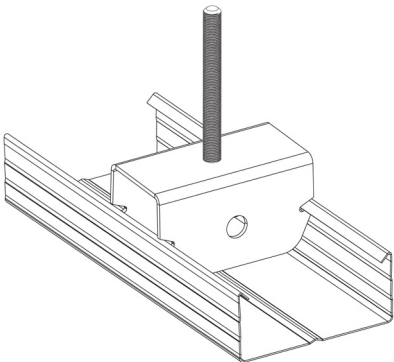
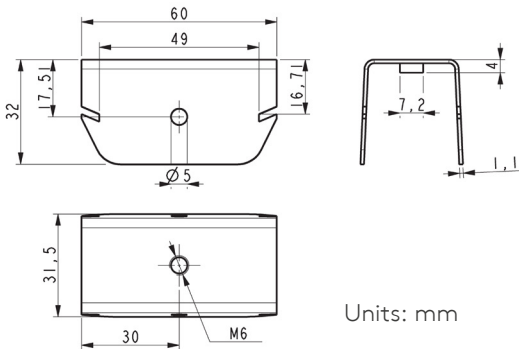

TECHNICAL CHARACTERISTICS

CHARACTERISTICS		DECLARED VALUE / CLASS
FIRE RESISTANCE		Class A1 according to standard UNE EN 13501-1
LOAD CAPACITY	Load process level	400 N according to tests carried out
	Load failure level	PND
DURABILITY	Saline chamber resistance	72 h according to standard ISO 9227
	Type of exposure	B
	Coating	Z100 according to standard EN 10346



Made of DX51D steel with a nominal thickness of 1.5 mm and hot-dipped galvanized finish.

Manufactured in accordance with the provisions of EU directive 89/106/EEC for construction products that are used in accordance with the EN 13.964:2014 standard for suspended ceiling kits.

Complies with the CE marking requirement of the EN 13964:2014 standard in Annexes ZA.1.4 and ZA.2 system 4.

REFERENCES AND PACKAGING

CHARACTERISTICS	VALUE
National classification	73269094/90
Barcode	8436574720273
Quantity per box	50 units
Quantity per pallet	12,600 units
Weight per box	2.23 kg

The data on this sheet has been provided by our supplier. In no case does it constitute a legal guarantee regarding the properties and/or functionality regarding the use of the component.

Teczone Española S.A.U. reserves the right to modify the contents of this document without any prior warning. Every effort has been made to ensure that the content of this publication is accurate, but Teczone Española S.A.U. and its affiliated companies are not responsible for errors or information that may be misleading. Suggestions regarding the final use or application of the products or work methods are merely informative and Teczone Española S.A.U. and its affiliates do not accept any responsibility in this regard.